

| REVISIONS | | | | |
|-----------|------|---------------------------|-----------|----------|
| ZONE | REV. | DESCRIPTION | DATE | APPROVED |
| | A | ADDED PINOUT TABLE | 20-Dec-10 | BS |
| | B | ADDED HOUSING DIMENSIO SN | 08-Mar-21 | MN |

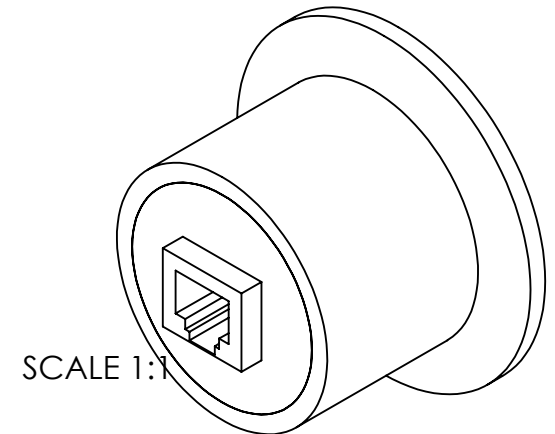
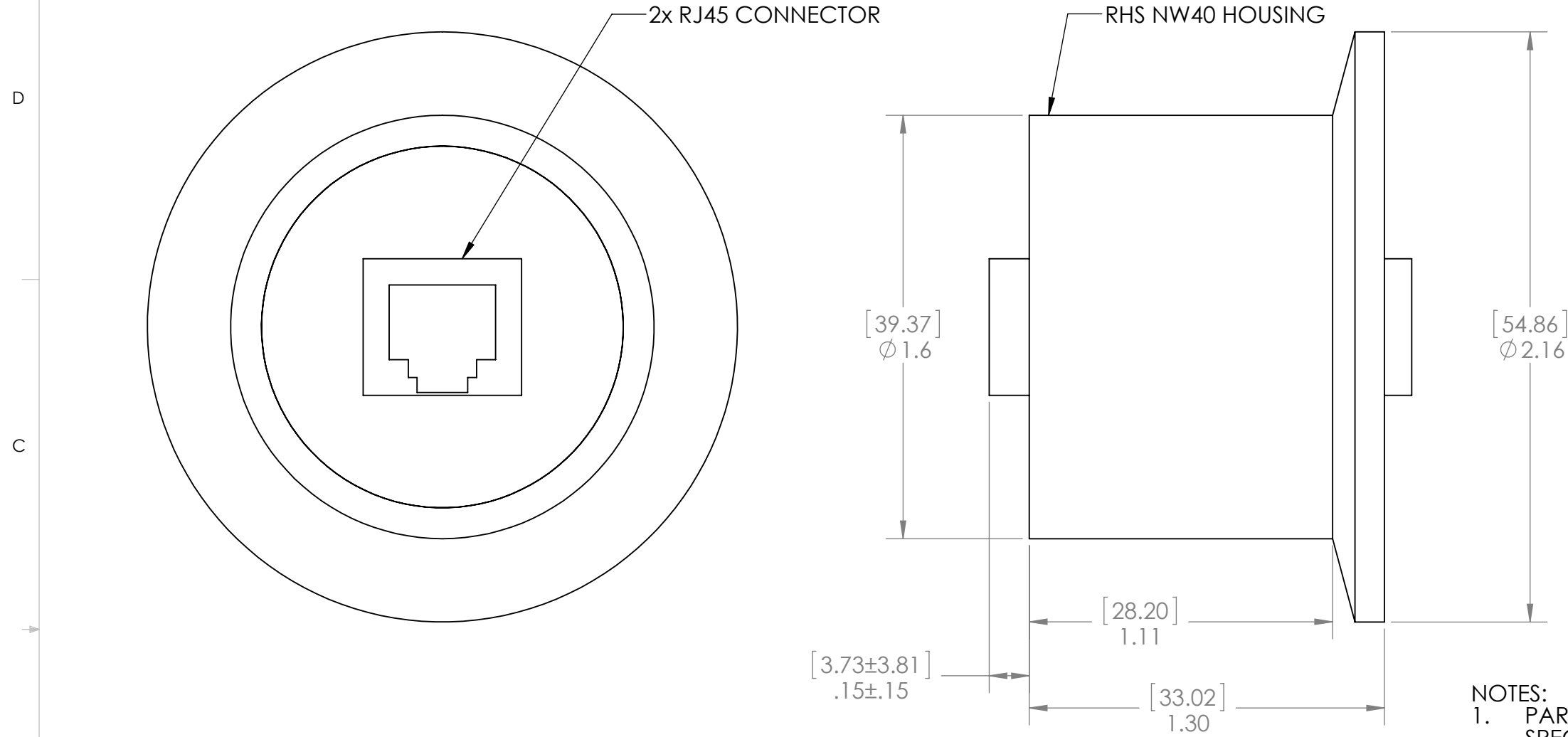

| PINOUT | |
|-----------------|-----------------|
| PIN HEX SIDE | PIN THREAD SIDE |
| 1 | 1 |
| 2 | 2 |
| 3 | 3 |
| 4 | 4 |
| 5 | 5 |
| 6 | 6 |
| 7 | 7 |
| 8 | 8 |
| SHIELD(SEE P/N) | SHIELD(SEE P/N) |

SAMPLE RHS PART# CCRJ45NW40-S610V0

- NOTES:
- PART TESTED PER PART NUMBER AND HERMETIC SEAL SPECIFICATIONS.
 - CUSTOM SIZES, MATERIALS, & TESTS AVAILABLE, PLEASE CONTACT RHS FOR MORE INFORMATION.
 - DIMENSIONS INCHES [MILLIMETERS], MILLIMETERS SHOWN FOR REFERENCE ONLY.

DETERMINING RHS PART#

- CC=CONNECTOR TO CONNECTOR SEALS
- RJ45=STANDARD RJ45 CONNECTORS
- NW40=STANDARD NW, QF, or KF STYLE VACUUM FLANGE
- HOUSING MATERIAL:
S6=316 STAINLESS STEEL, A1=6016 ALUMINUM, B1=BRASS, I6=600 INCOLNEL, OR T2=GRADE 2 TITANIUM
- LEAK TESTING:
 - 1=HELIUM LEAK TEST @ 1 ATM 10X10⁻⁸ STD-CC/SEC OR BETTER
 - 2=100 PSI(6.9 BAR) AIR ON THREAD SIDE OF O-RING NO BUBBLES
 - 3=100 PSI(6.9 BAR) AIR ON HEX SIDE OF O-RING NO BUBBLES
 - 4=1000 PSI(69 BAR) AIR ON THREAD SIDE OF O-RING NO BUBBLES
 - 5=1000 PSI(69 BAR) AIR ON HEX SIDE OF O-RING NO BUBBLES
 - 6=2500 PSI(172 BAR) AIR ON THREAD SIDE OF O-RING NO BUBBLES
 - 7=5000 PSI(345 BAR) AIR ON HEX SIDE OF O-RING NO BUBBLES
 - 8=3500 PSI(243 BAR) AIR ON THREAD SIDE OF O-RING NO BUBBLES & HELIUM LEAK TEST @ 1 ATM 10x10⁻⁹ STD-CC/SEC OR BETTER
 - 9=HELIUM LEAK TEST @ 1 ATM 10X10⁻⁹ STD-CC/SEC OR BETTER
- 0=RJ45 BODY ISOLATED FROM HOUSING OR 1=RJ45 BODY CONNECTED (SHORTED) TO HOUSING <200mOhms
- O-RING MATERIAL:
A=POLYACRYLATE, B=BUTYL, C=CLOROPRENE, E=ETHYLENE-PROPYLENE, G=STYRENE BUTADIENE, L=FLUOROSILICONE, N=ACRYLONITRILE BUTADIENE (NITRILE), P=POLYURETHANE, S=SILICONE, V=FLUOROCARBON (VITON), Y=EPICHLOROHYDRIN, Z=EXOTIC OR SPECIALTY
- 0=CONNECTORS SHIELD TO SHIELD SHORTED OR 1=CONNECTORS SHIELD TO SHIELD OPEN

| HERMETIC SEAL SPECIFICATIONS | |
|---|--------------------------------|
| LEAK: | |
| LEAK TEST | SEE RHS PART# |
| ELECTRICAL: | |
| INSULATION RESISTANCE TEST (CONDUCTOR TO CONDUCTOR) | >500 MOhms @ 500 VDC |
| CONDUCTOR END TO END RESISTANCE TEST | <50 mOhms |
| ENVIRONMENTAL: | |
| TEMPERATURE RANGE (LOW TEMP O-RING DEPENDANT) | -55°C TO 85°C (-67°F TO 185°F) |

UNLESS OTHERWISE SPECIFIED:
 DIMENSIONS ARE IN INCHES
 TOLERANCES:
 FRACTIONAL ±1/16
 ANGULAR ±.5
 X. ±1 .X ±.1
 .XX ±.02 .XXX ±.005
 DIMENSIONS ARE SUBJECT TO CHANGE WITHOUT NOTICE

INTERPRET GEOMETRIC TOLERANCING PER:
 MATERIAL SEE PART#
 FINISH N/A

DO NOT SCALE DRAWING

| | NAME | DATE |
|-----------|------|-----------|
| DRAWN | MM | 7/15/2010 |
| CHECKED | BS | 7/15/2010 |
| ENG APPR. | | |
| MFG APPR. | | |
| Q.A. | | |



PROPRIETARY AND CONFIDENTIAL

THE INFORMATION CONTAINED IN THIS DRAWING IS THE SOLE PROPERTY OF RELIABLE HERMETIC SEALS. ANY REPRODUCTION IN PART OR AS A WHOLE WITHOUT THE WRITTEN PERMISSION OF RELIABLE HERMETIC SEALS IS PROHIBITED.

| | | | |
|-----------------------------------|------------------|------------------------|-----------------|
| TITLE: HERMETIC CONNECTOR RJ45 | SIZE B | DWG. NO. CCRJ45NW40 | REV B |
| SCALE: 2:1 | WEIGHT: | SHEET 1 OF 1 | |